

RETURN TO BASKETBALL

P L A Y E R G U I D E L I N E S



COMING TO OUR STADIUM'S

Knox Basketball are under strict restrictions when we return to basketball. As such, we need everyone involved to work together and follow our directives.

Our first step is to ensure no one enters the stadium if they are feeling unwell

Please refer to the document to the right and follow all directives.

DO NOT ENTER

IF YOU HAVE ANY OF THE FOLLOWING SYMPTOMS:



FEVER



COUGHING



FATIGUE



SHORTNESS OF
BREATH



SORE THROAT



PLEASE STAY AT HOME IF UNWELL

FACE MASKS

Face masks are no longer mandatory, but Knox Basketball encourages the use of face masks in crowded areas, such as when you are a spectator at a game.

The infographic features a dark blue background with a lighter blue diagonal stripe on the right side. At the top left, there are three circular icons: a hand with droplets, two people with a double-headed arrow, and a building. To the right of these icons is the text 'CORONAVIRUS (COVID-19) IN VICTORIA'. The main title 'ADVICE FOR WEARING FACE MASKS' is written in large, bold, white capital letters. To the right of the title is a circular illustration of a person wearing a light blue face mask. At the bottom left, there is white text providing a website and a phone number. At the bottom right, there are three logos: 'BetterHealth Channel' with an apple icon, the 'VICTORIA State Government' logo, and the 'Health and Human Services' logo.

   CORONAVIRUS (COVID-19) IN VICTORIA

ADVICE FOR WEARING FACE MASKS



Visit www.dhhs.vic.gov.au/coronavirus
If you have questions, call 1800 675 398

WHEN YOU ARRIVE

EVERYONE who enters any stadium must check in. That means participants, family of participants, staff/ volunteers and coaches.

You can check in via the following links OR via the QR Code's near stadium entry points.

Please check in no earlier than 5 minutes before entering the venue, and if you check in before the venue make sure you do not close the confirmation page until you show KBI staff.

The whole family can be checked in on one form.

YOU WILL NOT BE ALLOWED INSIDE THE VENUE UNLESS YOU SHOW THE COMPLETED FORM UPON ENTERING. DO NOT CLOSE THE PAGE UNTIL YOU WALK IN.

SBC: bit.ly/sbccheckin

Boronia: bit.ly/boroniacheckin

External Venue: bit.ly/kbicheckin

External venue's are any venue not SBC or Knox Basketball Stadium.



ONCE YOU GET INSIDE

Complete the following steps:

1. **Sanitise your hands**
2. **Follow social distancing rules and proceed to your court**

If you would like to utilise the cafe, you must adhere to social distancing regulations. You will see signage around the stadiums and on floors to help you with this.

PLEASE PAY WITH EFTPOS
WHEREVER POSSIBLE.



HAND SANITISATION STATIONS

State Basketball Centre

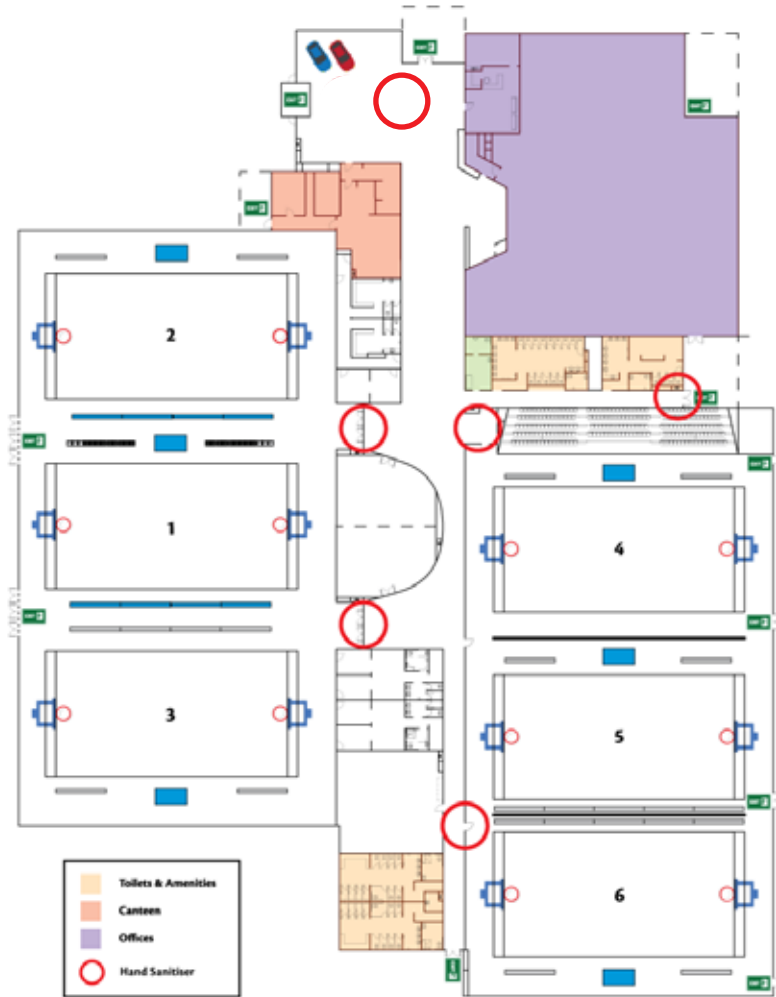

Knox Basketball Stadium

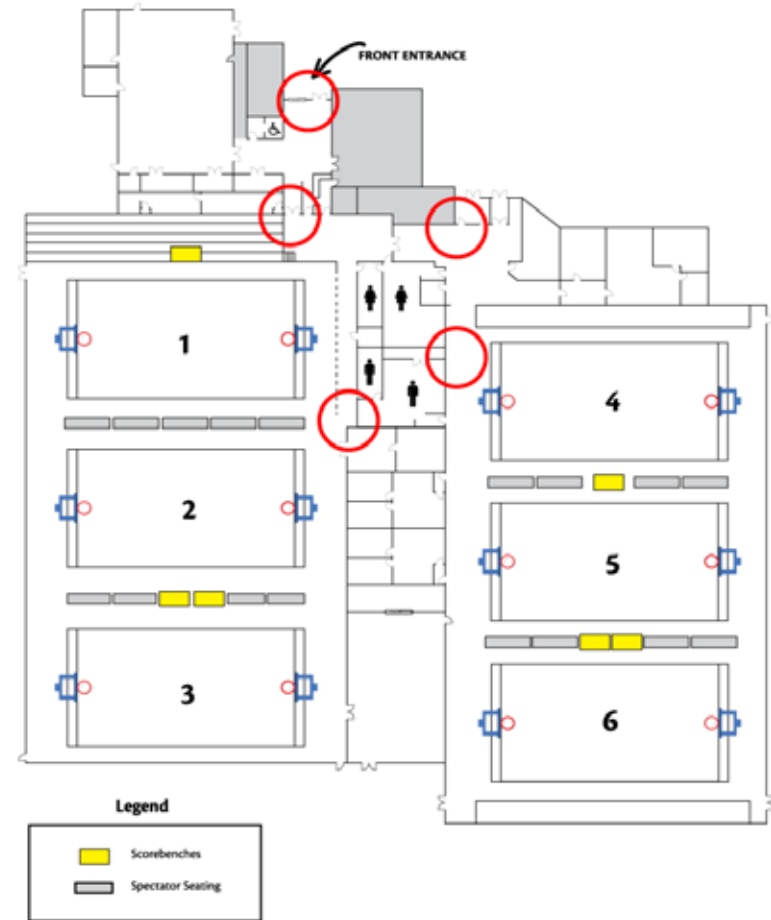

PARENTS, GUARDIANS AND GUESTS

We are now permitted to have 150 people per court, which enables Knox Basketball to allow all spectators for Junior and Senior Domestic to come to games.

BIO-SAFETY OFFICERS

Stadiums will have bio safety officers working at all times. They will be easily identifiable in hi-vis clothing. It is their job to ensure the stadium is sanitised both during and between sessions. Please follow their requests.

If an area exceeds the total amount of people allowed, they have the right to ask you to move.

IF YOU OR A FAMILY MEMBER TEST POSITIVE

Once you have followed the advice of the government's COVID-19 Hotline and your GP, it is imperative that you contact Knox Basketball.

You will need to advise us of the time and date you were in the venue and what court you were on.

Contact details:

NATHAN SEWELL - VENUE AND FACILITIES MANAGER

0437 959 829

Novel Coronavirus in Victoria

Concerned? Call the Coronavirus
hotline 1800 675 398
Please keep Triple Zero (000)
for emergencies only.



1 PAGE CHEAT SHEET FOR RETURN TO BASKETBALL

1. Stay home if you are unwell. Especially if you have a fever, are coughing, feeling fatigued, have shortness of breath or a sore throat.
2. Try to limit arriving early.
3. Check in either in your car when you arrive, while you're walking from your vehicle to the door, or while entering the stadium. You will need to show a staff member that you have checked in to be allowed to enter so do not close this page.
SBC: bit.ly/sbccheckin
Boronia: bit.ly/boroniacheckin
External: bit.ly/kbicheckin
4. Maintain social distancing in the stadium.
5. Adhere to density limitations.
7. Listen to staff and bio-safety officers at all times.
8. Depart quickly after your session.
9. If you test positive, notify us immediately.

