

# RETURN TO BASKETBALL

---

P L A Y E R   G U I D E L I N E S



# COMING TO OUR STADIUM'S

Knox Basketball are under strict restrictions when we return to basketball. As such, we need everyone involved to work together and follow our directives.

Our first step is to ensure no one enters the stadium if they are feeling unwell

Please refer to the document to the right and follow all directives.

# DO NOT ENTER

IF YOU HAVE ANY OF THE FOLLOWING SYMPTOMS:



FEVER



COUGHING



FATIGUE



SHORTNESS OF  
BREATH



SORE THROAT



PLEASE STAY AT HOME IF UNWELL

# FACE MASKS

Face masks are not required during games for Players, Referees & Coaches while on court.

Masks are recommended, but not mandatory, for all patrons aged 12 years or older when social distancing cannot be maintained.

All spectators, coaches and managers must keep their face covering on throughout their time in the stadium.

 CORONAVIRUS (COVID-19) IN VICTORIA

**ADVICE  
FOR WEARING  
FACE MASKS**

Visit [www.dhhs.vic.gov.au/coronavirus](http://www.dhhs.vic.gov.au/coronavirus)  
If you have questions, call 1800 675 398

  Health and Human Services

# WHEN YOU ARRIVE

EVERYONE who enters any stadium must check in. That means participants, family of participants, staff/ volunteers and coaches.

You can check in via the following links OR via the QR Code's near stadium entry points.

Please check in no earlier than 5 minutes before entering the venue, and if you check in before the venue make sure you do not close the confirmation page until you show KBI staff.

The whole family can be checked in on one form.

**YOU WILL NOT BE ALLOWED INSIDE THE VENUE UNLESS YOU SHOW THE COMPLETED FORM UPON ENTERING. DO NOT CLOSE THE PAGE UNTIL YOU WALK IN.**

SBC: [bit.ly/sbccheckin](https://bit.ly/sbccheckin)

Boronia: [bit.ly/boroniacheckin](https://bit.ly/boroniacheckin)

External Venue: [bit.ly/kbicheckin](https://bit.ly/kbicheckin)

External venue's are any venue not SBC or Knox Basketball Stadium.



# ONCE YOU GET INSIDE

Complete the following steps:

1. **Sanitise your hands**
2. **Follow social distancing rules and proceed to your court**

If you would like to utilise the cafe, you must adhere to social distancing regulations. You will see signage around the stadiums and on floors to help you with this.

PLEASE PAY WITH EFTPOS  
WHEREVER POSSIBLE.



# HAND SANITISATION STATIONS

## State Basketball Centre

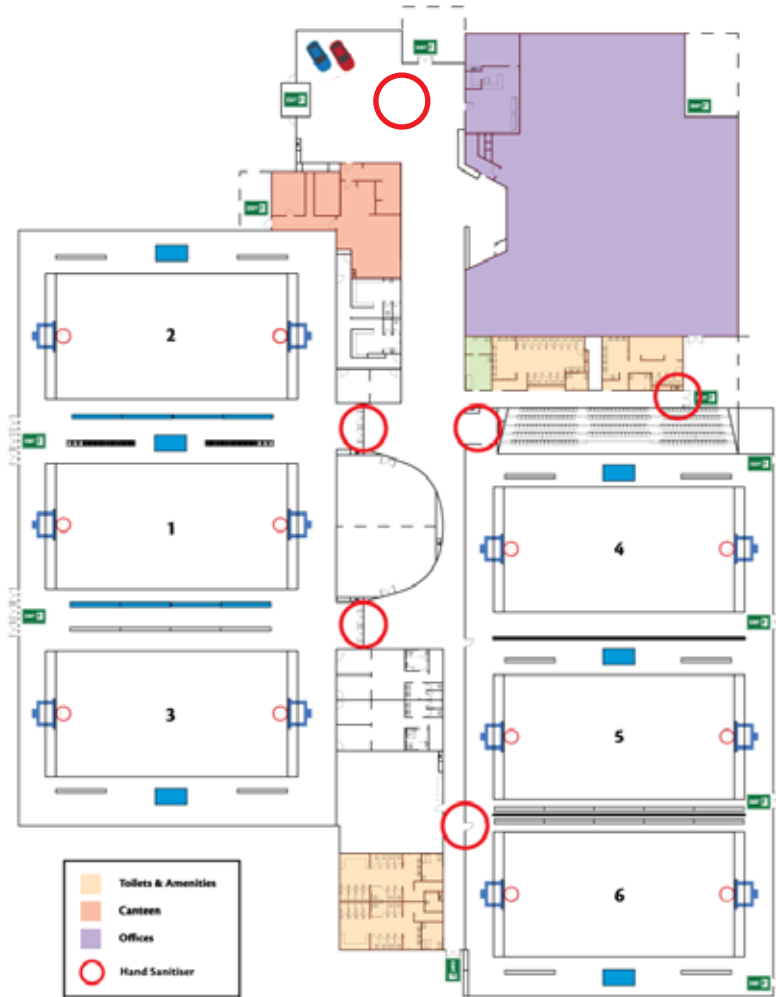

## Knox Basketball Stadium

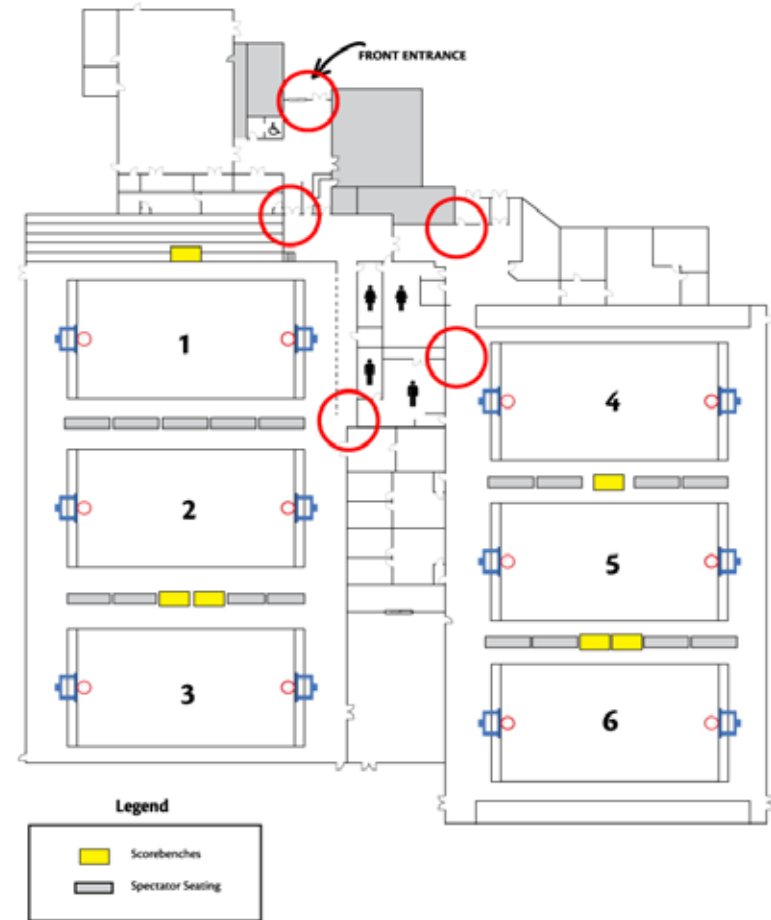

### Legend

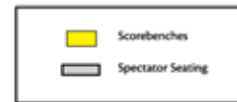

# PARENTS, GUARDIANS AND GUESTS

We are now permitted to have 150 people per court, which enables Knox Basketball to allow all spectators entry for Junior and Senior Domestic to come to games.

**If an area exceeds the density limit or social distancing is not being adhered, Knox Basketball staff have the right to ask you to move. We ask that you please accommodate these requests.**

# IF YOU OR A FAMILY MEMBER TEST POSITIVE

Once you have followed the advice of the government's COVID-19 Hotline and your GP, it is imperative that you contact Knox Basketball.

You will need to advise us of the time and date you were in the venue and what court you were on.

## **Contact details:**

**NATHAN SEWELL - VENUE AND FACILITIES MANAGER**

**0437 959 829**

## **Novel Coronavirus in Victoria**

Concerned? Call the Coronavirus  
hotline 1800 675 398  
Please keep Triple Zero (000)  
for emergencies only.





# 1 PAGE CHEAT SHEET FOR RETURN TO BASKETBALL

1. Stay home if you are unwell. Especially if you have a fever, are coughing, feeling fatigued, have shortness of breath or a sore throat.
2. Try to limit arriving early.
3. Check in either in your car when you arrive, while you're walking from your vehicle to the door, or while entering the stadium. You will need to show a staff member that you have checked in to be allowed to enter so do not close this page.  
SBC: [bit.ly/sbccheckin](https://bit.ly/sbccheckin)  
Boronia: [bit.ly/boroniacheckin](https://bit.ly/boroniacheckin)  
External: [bit.ly/kbicheckin](https://bit.ly/kbicheckin)
4. Maintain social distancing in the stadium.
5. Adhere to density limitations.
7. Listen to staff at all times.
8. Depart quickly after your session.
9. If you test positive, notify us immediately.

